

# RH2580BR

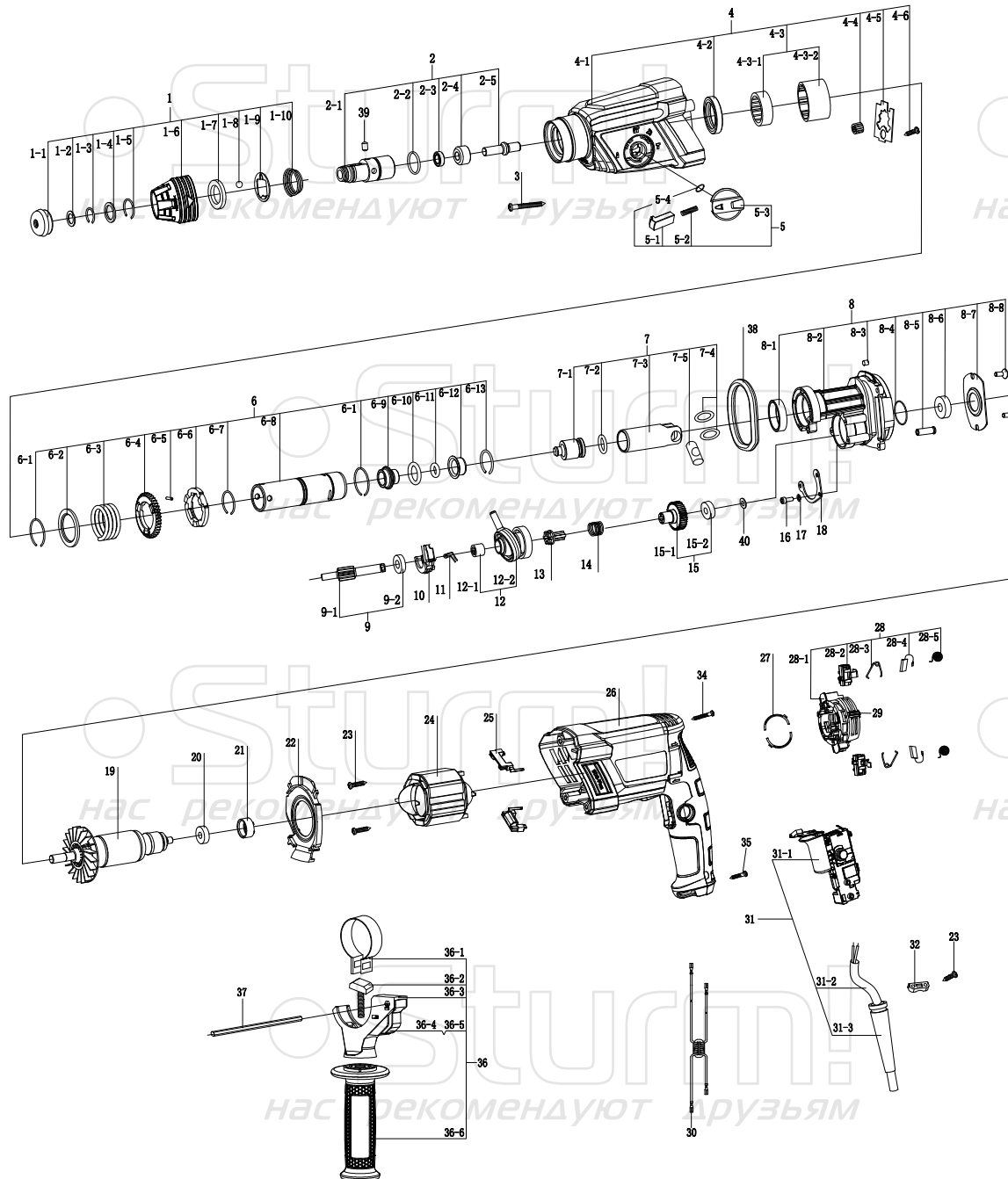

NO.	DESCRIPTION	NO.	DESCRIPTION
1	PROTECTIVE SLEEVE ASSY	8-4	O-RING
1-1	PROTECTIVE CAP	8-5	PIN
1-2	WASHER	8-6	BALL BEARING 609-2RS
1-3	SNAP RING	8-7	BINDER PLATE
1-4	RETAINING RING	8-8	M4X10 SCREW
1-5	SNAP RING	9	TOOTHED SHAFT ASSY
1-6	PROTECTIVE SLEEVE	9-1	TOOTHED SHAFT
1-7	THRUST RING	9-2	BALL BEARING 699
1-8	BALL	10	SHIFT FORK
1-9	HOLDING PLATE	11	SPRING CLIP
1-10	COMPRESSION SPRING	12	DRIVE END SHIELD ASSY
2	DRILL BUSHING ASSY	12-1	NEEDLE BEARING HK0908
2-1	DRILL BUSHING	12-2	DRIVE END SHIELD
2-2	O-RING	13	CLUTCH
2-3	OIL SEAL	14	SPRING
2-4	SNAP RING	15	CYLINDRICAL GEAR ASSY
2-5	IMPACT BOLT	15-1	CYLINDRICAL GEAR
3	ST4.8X45 SCREW	15-2	BALL BEARING 607
4	GEAR HOUSING ASSY	16	M4X12 SCREW
4-1	GEAR HOUSING	17	SPRING
4-2	OIL SEAL	18	METAL PLATE
4-3	BEARING SLEEVE ASSY	19	ROTOR
4-3-1	NEEDLE SLEEVE HK3012	20	BALL BEARING 607
4-3-2	BEARING SLEEVE	21	RUBBER BEARING SLEEVE
4-4	NEEDLE SLEEVE HK0709	22	AIR DEFLECTOR RING
4-5	TAB WASHER	23	ST3.9X16 SCREW
4-6	ST4.2X13 SCREW	24	STATOR
5	SELECTOR KNOB ASSY	25	RUBBER BEARING SLEEVE
5-1	SWITCH BUTTON	26	HOUSING
5-2	COMPRESSION SPRING	27	HOLDING PLATE
5-3	SELECTOR KNOB	28	BRUSH HOLDER ASSY
5-4	O-RING	28-1	BRUSH HOLDER
6	RATCHET SLEEVE ASSY	28-2	COPPER BRUSH HOLDER
6-1	SNAP RING	28-3	SPRING CLIP
6-2	SUPPORTING DISC	28-4	CARBON BRUSH
6-3	COMPRESSION SPRING	28-5	SPRING
6-4	CYLINDRICAL GEAR	29	R/L BUTTON
6-5	STRAIGHT PIN	30	INDUCTOR
6-6	CATCH DISC	31	SWITCH ASSY
6-7	SNAP RING	31-1	SWITCH
6-8	RATCHET SLEEVE	31-2	CABLE
6-9	GUIDE BUSHING	31-3	CABLE GUARD
6-10	O-RING	32	CABLE CLIP
6-11	O-RING	34	ST4.2X32 SCREW
6-12	DAMPING BUSHING	35	ST4.2X18 SCREW
6-13	SNAP RING	36	AUXILIARY HANDLE ASSY
7	PISTON ASSY	36-1	CLAMPING BAND
7-1	STRIKER	36-2	T-BOLT
7-2	O-RING	36-3	CLAMP HOLDER
7-3	PISTON	36-4	RED BUTTON
7-4	SHIM RING	36-5	COMPRESSION SPRING
7-5	PISTON PIN	36-6	AUXILIARY HANDLE
8	INTERMEDIATE FLANGE ASSY	37	DEPTH GAUGE
8-1	BUSHING	38	O-RING
8-2	INTERMEDIATE FLANGE	39	PIN
8-3	OIL FELT	40	WASHER